

Clubside C3

- 1,293 Sq. Feet
- Balcony 126 sq. ft.
- 2 Bedroom
- 2 Bath

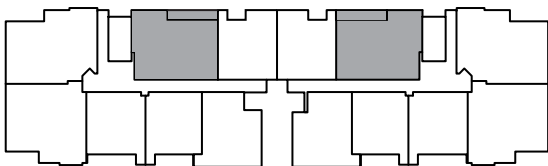

2ND-5TH FLOOR



The Royal



Plans and furnishings are for marketing purposes only and are not to scale. All measurements are approximate and may vary from actual unit dimensions. Floor plans, layouts, features, and availability are subject to change without notice. Some images may be virtually staged for illustrative purposes only. Actual locations may vary, and items shown—or omitted—are subject to errors, omissions, and field modifications. This flyer is for informational purposes only and does not constitute a binding agreement. For more details or to discuss modifications for enhanced accessibility, please contact the leasing office.



**PARK
LANE**
AT GARDEN STATE PARK

1 Park Lane Boulevard
Cherry Hill, NJ 08002
Phone: 856.662.1600